

5.02

Plovbolte
Radrenserbolte
Sikringsbolte

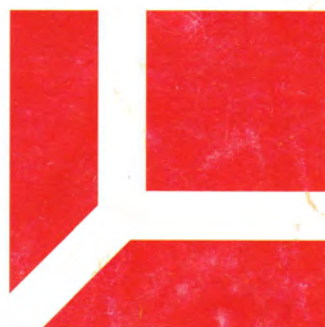

GRENE

Radrenserbolte/spidsbolte	
Radrenserbolte/spidsbolte	2.007
Kverneland Sagita	2.007
Lemken vingeskær	2.007
Marsk Stig	2.007
Prela	2.007
Sikringsbolt	
Dowdesweld	2.008
Kongskilde/Skjold	2.008
Kverneland/Fraugde	2.008
Naud	2.008
Spidsbolt, se radrenserbolt	
Stålplovbolt	
1 næse	2.006
2 næser	2.006
Konisk hoved	2.005
Lille hoved	2.005
Millimeter	2.003
Tommer	2.004

Stålplovbolte i millimeter

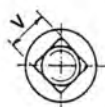
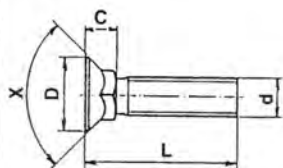

d	L	Kv.	Pk.str.	Grp. - varenr.
M10 x 25 mm		8.8	100	5000-1025
M10 x 30 mm		8.8	100	5000-1030
M10 x 35 mm		8.8	100	5000-1035
M10 x 40 mm		8.8	100	5000-1040
M10 x 45 mm		8.8	100	5000-1045
M10 x 50 mm		8.8	50	5000-1050
M10 x 60 mm		8.8	50	5000-1060
M10 x 75 mm		8.8	50	5000-1075
M12 x 30 mm		12.9	50	5000-1230
M12 x 35 mm		12.9	50	5000-1235
M12 x 40 mm		8.8	50	5000-1240
M12 x 45 mm		12.9	50	5000-1245
M12 x 50 mm		8.8	50	5000-1250
M12 x 55 mm		8.8	50	5000-1255
M12 x 55 mm		12.9	50	5000-1256
M12 x 60 mm		8.8	50	5000-1260
M12 x 70 mm		8.8	50	5000-1270
M12 x 80 mm		12.9	50	5000-1280
M12 x 90 mm		8.8	50	5000-1290
M16 x 50 mm		8.8	25	5000-1650
M16 x 70 mm		8.8	25	5000-1670
M16 x 80 mm		8.8	25	5000-1680
M16 x 90 mm		8.8	25	5000-1690

Målskema

d	M10	M12	M16
x	90 grd.	90 grd.	90 grd.
D	19	24	32
c	8,0	10,5	13,5
v	10	12	16

Stålplovbolte i tommer

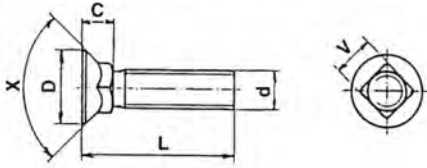

d	L	Kv.	Pk.str.	Grp. - varenr.
3/8"	x 25 mm	8.8	100	5001-1025
3/8"	x 30 mm	8.8	100	5001-1030
3/8"	x 35 mm	8.8	100	5001-1035
3/8"	x 40 mm	8.8	100	5001-1040
3/8"	x 45 mm	8.8	100	5001-1045
7/16"	x 30 mm	8.8	100	5001-1130
7/16"	x 35 mm	8.8	100	5001-1135
7/16"	x 40 mm	8.8	100	5001-1140
7/16"	x 45 mm	8.8	50	5001-1145
7/16"	x 50 mm	8.8	50	5001-1150
7/16"	x 55 mm	8.8	50	5001-1155
7/16"	x 60 mm	8.8	50	5001-1160
1/2"	x 45 mm	8.8	50	5001-1345
1/2"	x 50 mm	8.8	50	5001-1350
1/2"	x 70 mm	8.8	25	5001-1370
1/2"	x 80 mm	8.8	50	5001-1380
5/8"	x 45 mm	8.8	25	5001-1645
5/8"	x 50 mm	8.8	25	5001-1650
5/8"	x 60 mm	8.8	25	5001-1660
5/8"	x 65 mm	8.8	25	5001-1665
5/8"	x 70 mm	8.8	25	5001-1670
5/8"	x 75 mm	8.8	25	5001-1675
5/8"	x 80 mm	8.8	25	5001-1680
5/8"	x 85 mm	8.8		5001-1685
3/4"	x 65 UNC	8.8		5007-2065
3/4"	x 90 UNC	8.8		5007-2090

Målskema UNF

d	3/8" UNF	7/16" UNF	1/2" UNF	5/8" UNF
x	80 grd.	80 grd.	80 grd.	80 grd.
D	15	18	21	24
c	7,0	8,0	9,0	9,0
v	9,9	11,2	12,8	16,0

Målskema UNC

d	3/8" UNC	1/2" UNC	5/8" UNC	3/4" UNC
D	15	21	24	31
c	7,0	9,0	8,5	12,0

M/konisk hoved, Kv 12.9 passende t/bl.a. Kverneland

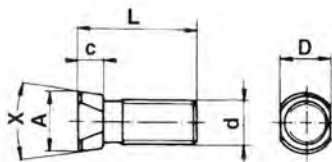

Målskema

d	Kon. M12	Kon. M14	Kon. M16
D	13,4	17,0	19,4
c	8	7	9
X	20	15	15
A	16,5	18	20,8



d	L	Pk.str.	Grp. - varenr.
M12 x 34 mm	Konisk bolt m/høj hoved, spec. t/Mølbør spidser	50	5007-1232
M12 x 34 mm	Konisk bolt t/øvrige Kverneland spidser	100	5040-013228
M12 x 38 mm	Konisk bolt m/høj hoved, Spec. t/Mølbør spidser v/ anv. af landsidekniv	50	5007-1239
M12 x 40 mm	Konisk bolt t/øvrige Kverneland spidser v/ anv. af landsidekniv	50	5007-1238
M14 x 34 mm	Konisk bolt t/Kverneland	50	5040-013332
M16 x 40 mm	Konisk plovbolt	50	5007-1640
M16 x 50 mm	Konisk plovbolt	50	5007-1650
M16 x 70 mm	Konisk plovbolt t/Kverneland	50	5040-032774
M16 x 80 mm	Konisk plovbolt	25	5007-1680
M16 x 85 mm	Konisk plovbolt MM-flangemøtrik passende til spec. Kverneland værktøj	25	5007-1685 5008-14
M16 x 65 mm	T/5020-303107 grubbespids		5020-031965
M16 x 75 mm	T/5020-303110 grubbespids		5020-031975

Koniske bolte: D-målet målt på smalleste sted

Konisk, Kv 12.9 til Kongskilde/Skjold, fra okt. 1987

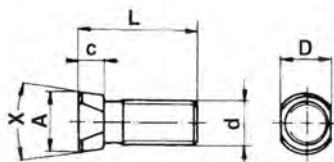

d	L	Pk.str.	Grp. - varenr.
7/16" x 32 mm UNC		50	5100-90373132
M12 x 28 mm		50	5100-90383128
90383132 erst. af		50	5040-013228
M12 x 40 mm		50	5100-90383140
M12 x 45 mm		50	5100-00323274

M/lille hoved, Kv 8.8 til Kongskilde/Skjold, til okt. 1987

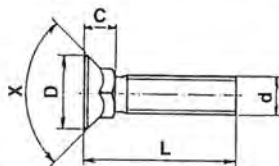

Målskema

d	M10	M12
x	90 grd.	90 grd.
D	18	21
c	6,0	7,3
v	10	10

d	L	Pk.str.	Grp. - varenr.
M10 x 30 mm		50	5100-90070009
M12 x 30 mm		50	5100-90070010
M12 x 35 mm		50	5100-90070011
M12 x 40 mm		50	5007-1240
M12 x 45 mm		50	5100-90070210

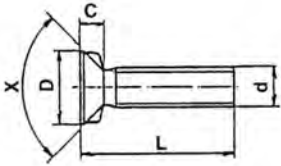
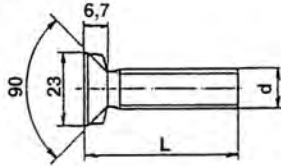
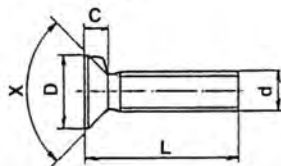
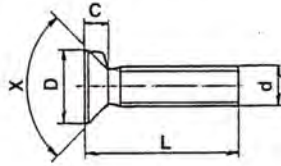
Med 2 næser					Grp. - varenr.																					
	d	L	Kv.	Pk.str.																						
	M10 x 25 mm	Galvaniseret	8.8	100	5006-1025																					
	M10 x 30 mm	Galvaniseret	12.9	100	5006-1030																					
	M10 x 32 mm	Specialbolt, sort, t/5060-80-604	12.9	100	5006-1032																					
	M10 x 33 mm	DIN 11014, sort	8.8	100	5006-1033																					
	M10 x 35 mm	Galvaniseret	12.9	50	5006-1035																					
	M10 x 50 mm	Galvaniseret	12.9	25	5006-1050																					
	M12 x 25 mm	Galvaniseret	12.9	50	5006-1225																					
	M12 x 30 mm	Galvaniseret	12.9	50	5006-1230																					
	M12 x 35 mm	Galvaniseret	12.9	50	5006-1235																					
	M12 x 40 mm	Galvaniseret	12.9	50	5006-1240																					
	M12 x 45 mm	Galvaniseret	12.9	50	5006-1245																					
	M12 x 50 mm	Galvaniseret	12.9	25	5006-1250																					
	M12 x 60 mm	Galvaniseret	12.9	50	5006-1260																					
	M14 x 30 mm	Galvaniseret	8.8	25	5006-1430																					
	M14 x 35 mm	Galvaniseret	8.8	25	5006-1435																					
	M14 x 40 mm	Galvaniseret	8.8	25	5006-1440																					
	M14 x 45 mm	Galvaniseret	8.8	25	5006-1445																					
M14 x 50 mm	Galvaniseret	8.8	25	5006-1450																						
M20 x 70 mm	Sort	10.9	50	5006-2070																						
M20 x 75 mm	Sort	10.9	20	5006-2075																						
M20 x 85 mm	sort	10.9	15	5006-2085																						
<p>Målskema</p> <table border="1"> <thead> <tr> <th>d</th> <th>M10</th> <th>M12</th> <th>M14</th> <th>M20</th> </tr> </thead> <tbody> <tr> <td>x</td> <td>90 grd.</td> <td>90 grd.</td> <td>90 grd.</td> <td>90 grd.</td> </tr> <tr> <td>D</td> <td>16</td> <td>20</td> <td>24</td> <td>33</td> </tr> <tr> <td>c</td> <td>4,4</td> <td>5,5</td> <td>7</td> <td>10</td> </tr> </tbody> </table>							d	M10	M12	M14	M20	x	90 grd.	90 grd.	90 grd.	90 grd.	D	16	20	24	33	c	4,4	5,5	7	10
d	M10	M12	M14	M20																						
x	90 grd.	90 grd.	90 grd.	90 grd.																						
D	16	20	24	33																						
c	4,4	5,5	7	10																						
<p>Med 2 næser, passende til Naud</p> 																										
d	L	Kv.	Pk.str.																							
M14 x 30 mm	Sort	12.9	50	5006-1431																						
M14 x 40 mm	Sort	12.9	25	5006-1441																						
M14 x 50 mm	Sort	12.9	25	5006-1451																						
M14 x 60 mm	Sort	12.9	25	5006-1461																						
<p>Med 1 næse</p> 																										
d	L	Kv.	Pk.str.																							
M10 x 30 mm	Sort	8.8	100	5008-1030																						
M12 x 35 mm	Sort	8.8	50	5008-1235																						
<p>Med 1 næse, passende til Dowdesweld</p> 																										
d	L	Kv.	Pk.str.																							
M12 x 35 mm	Kon., 4-fladet	10.9		5007-900812																						
M10 x 25 mm	Kon., 4-fladet	10.9		5007-9709925																						
M12 x 35 mm	Kon., 4-fladet	10.9		5007-9714735																						
7/16" x 45 mm	Kon., 4-fladet	10.9		5007-9764845																						
7/16" x 35 mm	Galvaniseret	8.8	50	5008-1135																						
7/16" x 45 mm			25	5008-1145																						
7/16" x 60 mm			25	5008-1160																						

Radrenserbolte/ spidsbolte					Grp. - varenr.																												
	d	L	Kv.	Pk.str.																													
	M8 x 33 mm	Sort	8.8	100	5003-0833																												
	M8 x 40 mm	Sort	8.8	100	5003-0840																												
	M10 x 37 mm	Sort	8.8	100	5003-1037																												
	M10 x 40 mm	Sort	8.8	100	5003-1040																												
	M10 x 45 mm	Sort	8.8	100	5003-1045																												
	M12 x 48 mm	Sort	8.8	50	5125-00323128																												
	M12 x 60 mm	Sort	8.8	25	5003-1260																												
	M12 x 70 mm	Sort	8.8	25	5003-1270																												
	<p>Målskema</p> <table border="1"> <thead> <tr> <th>d</th> <th>M8</th> <th>M10</th> <th>M12</th> </tr> </thead> <tbody> <tr> <td>x</td> <td>90 grd.</td> <td>90 grd.</td> <td>90 grd.</td> </tr> <tr> <td>A</td> <td>16,0</td> <td>19,0</td> <td>22,0</td> </tr> <tr> <td>B</td> <td>13,0</td> <td>15,0</td> <td>20,0</td> </tr> <tr> <td>c</td> <td>6,5</td> <td>7,5</td> <td>9,0</td> </tr> <tr> <td>R</td> <td>14,0</td> <td>16,0</td> <td>20,0</td> </tr> <tr> <td>v</td> <td>8,0</td> <td>10,0</td> <td>12,0</td> </tr> </tbody> </table>						d	M8	M10	M12	x	90 grd.	90 grd.	90 grd.	A	16,0	19,0	22,0	B	13,0	15,0	20,0	c	6,5	7,5	9,0	R	14,0	16,0	20,0	v	8,0	10,0
d	M8	M10	M12																														
x	90 grd.	90 grd.	90 grd.																														
A	16,0	19,0	22,0																														
B	13,0	15,0	20,0																														
c	6,5	7,5	9,0																														
R	14,0	16,0	20,0																														
v	8,0	10,0	12,0																														
Prela spidsbolt		d	L	Kv.	Pk.str.																												
		M8 x 25 mm	Galvaniseret	8.8	100	5005-08025																											
Marsk Stig spidsbolt		d	L	Kv.	Pk.str.																												
		3/8" x 35 mm	Sort	8.8	100	5001-1035																											
Bolte passende til Kverneland Sagita spidser		d	L	Kv.	Pk.str.																												
		M10 x 38 mm	Sort		50	5008-103015																											
Bræddebolt t/Lemken vingeskær		d	L	Kv.	Pk.str.																												
		M12 x 30 mm		10.9	25	5008-1230																											

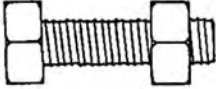
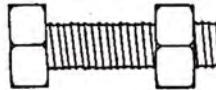
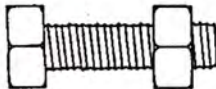
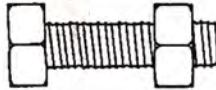
Kverneland/Fraugde	Benævnelse	Grp. - varenr.
	d L M20 x 63 mm Type LD m/3-delt lås & LB85	5009-035060
	M20 x 85 mm Type LA m/hel lås, 2 riller	5009-035061
	M20 x 98 mm Type LD m/hel lås, 2 riller	5009-035062
	M16 x 60 mm T/Fraugde super m/2 riller	5009-097840
	M16 x 70 mm Type VD	5009-035055
	M12 x 55 mm T/Fraugde Rondaflex	5009-097606
Kongskilde/Skjold 	d L M14 x 70 mm T/Variant M14 x 80 mm T/Exellent M14 x 90 mm T/Markant	5100-90350070 5100-90070029 5100-90070026
Dowdesweld 	d L 5/8" x 75 mm UNC Blå t/DP6, DP7 5/8" x 75 mm UNC Rød t/DP8 1/2" x 2 1/4" UNF T/rulleskær	5092-900481 5092-900486 5092-900483
Naud 	d L M14 x 55 mm Type RN	5090-62016436